

REFRIGERATOR MERCHANDISERS

| Model | Product ID | Size |
|-------------|------------|---------------------|
| TEGD-1DR-23 | 859656 | (1) Door, 23 cu ft |
| TEGD-2DR-48 | 859657 | (2) Doors, 48 cu ft |

STANDARD FEATURES

- Triple pane locking glass doors w/heat reflecting film
- Very bright LED lighting
- (4) Epoxy coated shelves per section
- Adjustable heavy duty coated shelves
- High density insulation
- Solid state temperature control w/digital display
- Removable door gaskets
- Whisper quiet, high efficient compressor
- Visually appealing to compliment products stored
- Economically designed door handle
- Bottom mount, slide out condenser



WARRANTY

ProCore Refrigeration equipment is warranted to be free from defects in material and workmanship under normal use and service for a period of 2 years for parts and labor. The compressor carries an additional 3 year warranty for the part only.

| Items | Description | Items | Description |
|---------------------|-------------------------------|----------------------|--|
| External top & side | Enamel coated steel | Temperature control | Solid state thermostat w/digital display |
| Door | Glass - triple pane, tempered | Comply to standard | NSF-7, UL-471 |
| External back | Aluminum | Refrigerating system | Capillary tube |
| Cabinet internal | White aluminum | Refrigerant | R134a |
| Internal floor | 300 Series stainless steel | Temp. range in box | 33°F to 41°F |
| Insulation | Polyurethane (CFC free) | Evaporator/condenser | Aluminum + copper |
| Shelves | Heavy duty, Epoxy coating | Condensing unit | Bottom |
| Lighting | LED | Door lock | Standard |

TEGD-1DR-23

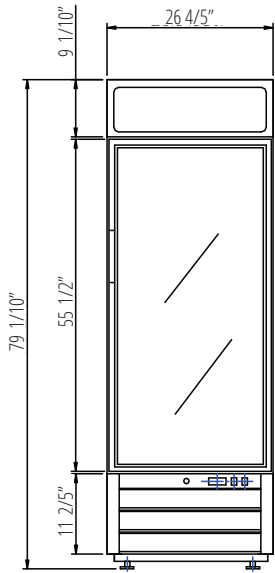

TEGD-2DR-48

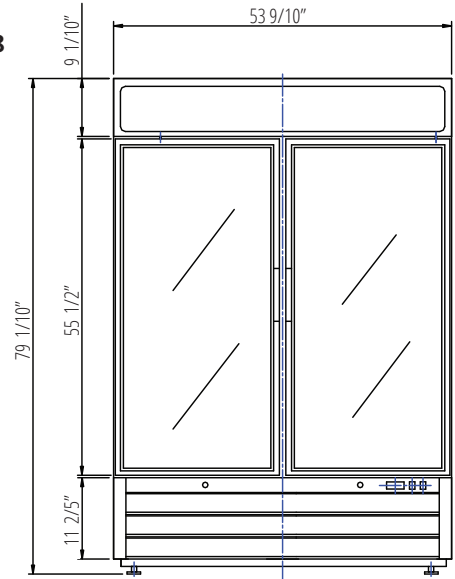

All Units

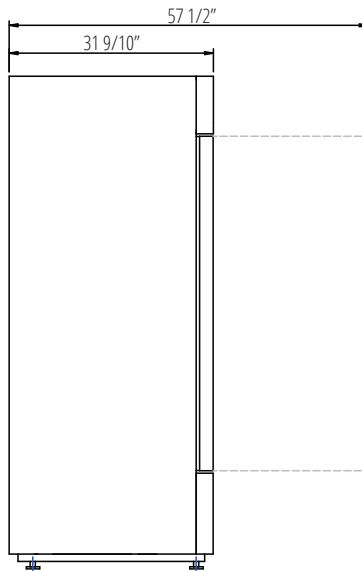

| Model | Product ID | # of Doors | Storage CAP (cu ft) | Shelves | Shelves Sizes (in) | Cabinet Dimensions (in) | | | HP | Voltage /Hz /ph | Amp | NEMA Plug | Cord Length (ft) | Crated Weight (lbs) |
|--------------------|------------|------------|---------------------|---------|--------------------|-------------------------|---------|---------|-----|-----------------|-----|-----------|------------------|---------------------|
| | | | | | | W | D | H | | | | | | |
| TEGD-1DR-23 | 859656 | 1 | 23 | 4 | 19 x 20 | 26 4/5 | 31 9/10 | 79 1/10 | 3/8 | 115/60/1 | 6 | 5-15P | 10 | 344 |
| TEGD-2DR-48 | 859657 | 2 | 48 | 8 | 22 x 27 | 53 9/10 | 31 9/10 | 79 1/10 | 1/2 | 115/60/1 | 7 | 5-15P | 10 | 540 |