



# Specifications

F.O.B Sedalia, Missouri 65301



WB303

### OPTIONS:

- Cold pan style top
- Drop type brackets for cutting board
- Stainless steel feet
- Adapter plates
- Stainless steel dish shelf under cutting board
- Trayslides & Workshelves
- Foodshields

### AGENCY LISTINGS:



**DUKE MANUFACTURING CO.**  
**2305 N. Broadway**  
**St. Louis, MO 63102**

**800.735.3853 Toll Free**  
**314.231.5074 Fax**  
**www.dukemfg.com**

SS-DM-0002-AFS-03

### Approval Stamp(s):

### PRODUCT INFORMATION:

PROJECT: \_\_\_\_\_

ITEM: \_\_\_\_\_

QUANTITY: \_\_\_\_\_

MODEL:

### Aerohot™ Foodservice

### Hot Food Units - Electric

- WB302** 2 top openings
- WB303** 3 top openings
- WB304** 4 top openings
- WB305** 5 top openings

### TOP:

- 20 gauge, stainless steel
- Die-stamped openings - 12" x 20"
- Poly carving board - 7"W x 1/2" thick with 18 gauge stainless steel support shelf and die-stamped brackets

### LINER:

- 18 gauge, stainless steel - 8" deep
- 1" cast brass drain and valve in wet bath

### BODY AND INTERIOR SHELF:

- 20 gauge, 430 Series stainless steel body
- 20 gauge, 430 Series stainless steel undershelf
- 430 Series stainless steel tubular legs with adjustable plastic feet

### CONTROLS:

- Natural or Propane, as specified
- Gas safety pilots standard
- Gas pressure regulator furnished in each unit
- Burners controlled by adjustable valve

### SHORT FORM SPECIFICATIONS:

**Aerohot™ Foodservice - Hot Food - Gas Wet Bath.** Heavy gauge tops w/ 430 series s/s body, under shelf and legs of heavy gauge 430 series s/s, open water bath w/adjustable gas valve control & safety point, 12"x 20", s/s top w/1/2" thick x 7" wide poly carving board, s/s open base w/under shelf, legs & feet. Unit shipped knocked down.

NOTE: Not available on casters

### SPECIFY NATURAL OR PROPANE

AEROHOT™ FOODSERVICE - HOT FOOD UNITS - GAS WET BATH

Catalog No. AFS-GASWET

A.I.A. File No. 35-C-13

REV A

# Aerohot®

**MODEL:**  
**Aerohot™ Foodservice**  
**Hot Food Units - Gas Wet Bath**

- WB302** 2 top openings
- WB303** 3 top openings
- WB304** 4 top openings
- WB305** 5 top openings

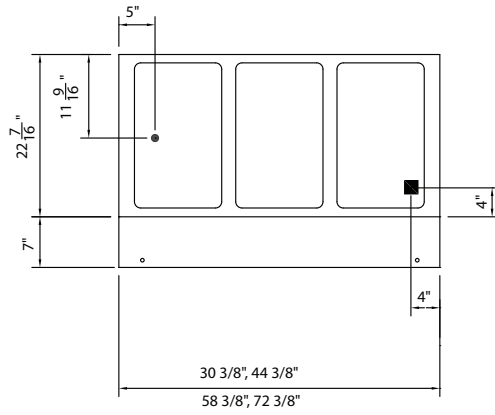

**TOP VIEW**

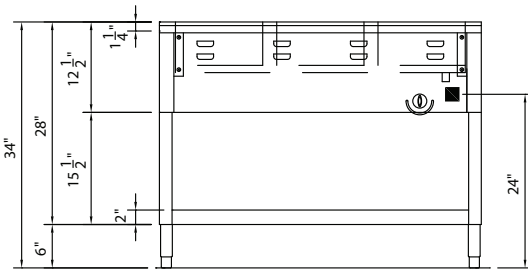

**FRONT VIEW**

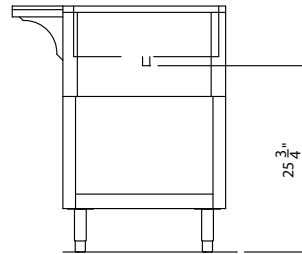

**RIGHT SIDE VIEW**

| LEGEND |                                    |
|--------|------------------------------------|
| ■      | - GAS CONNECTION                   |
| ●      | - DRAIN CONNECTION - 1" cast brass |

**DIMENSIONS:**

Freight Class: 85

| Model        | Length |       | Width   |      | Height |      | Top Openings | Cube ft. Crated | Weight |      |
|--------------|--------|-------|---------|------|--------|------|--------------|-----------------|--------|------|
|              | in     | cm    | in      | cm   | in     | cm   |              |                 | lbs    | kg   |
| <b>WB302</b> | 30-3/8 | 77.2  | 22-7/16 | 90.2 | 34     | 86.4 | 2            | 27.0            | 110    | 49.9 |
| <b>WB303</b> | 44-3/8 | 112.8 | 22-7/16 | 90.2 | 34     | 86.4 | 3            | 38.1            | 135    | 61.2 |
| <b>WB304</b> | 58-3/8 | 148.3 | 22-7/16 | 90.2 | 34     | 86.4 | 4            | 49.2            | 160    | 72.6 |
| <b>WB305</b> | 72-3/8 | 183.9 | 22-7/16 | 90.2 | 34     | 86.4 | 5            | 60.2            | 195    | 88.4 |

**POWER SUPPLY:** High altitude orifice available - specify elevation. **SPECIFY NATURAL OR PROPANE.** 1/2" connection

| Model        | Total BTU |
|--------------|-----------|
| <b>WB302</b> | 15,000    |
| <b>WB303</b> | 15,000    |
| <b>WB304</b> | 27,500    |
| <b>WB305</b> | 27,500    |

**NOTE:** No combustible materials should be stored on bottom shelf. NOT AVAILABLE IN PORTABLE MODELS. No provisions shall be made for overselves or trayslides to be mounted.



**DUKE MANUFACTURING CO.**

2305 N. Broadway  
 St. Louis, MO 63102

800.735.3853 Toll Free  
 314.231.1130 In Missouri  
 314.231.5074 Fax  
 www.dukemfg.com

Specification subject to change